

## Drain well box for slotted grate PCF 130 **PRATIKO**



PICF1320G



PICF1390G



PICF1314G

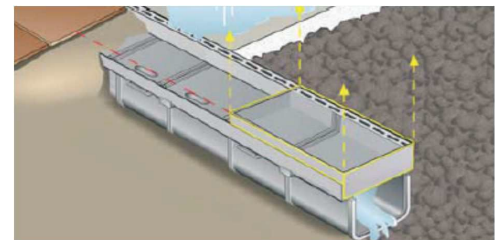
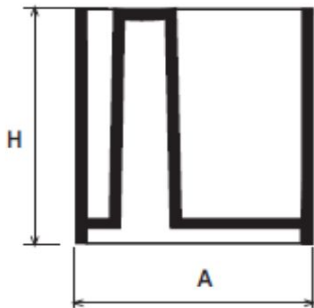

Item	A mm	H mm	L mm	Weight g
<b>PICF1320G</b>	128	40	200	240
<b>PICF1390G</b>	128	110	200	640
<b>PICF1314G</b>	128	160	200	920

**Material:** PVC-U

**Colour:** Light grey

**Features:** The drain well box for slotted grate must be filled with the material used for the floor. It allows inspection and cleaning of the channel.

- Area of water drainage (All models): 8,4 cm<sup>2</sup> (7,5 slits of length 20 mm)
- Drainage rate (All models): 1,6 lt/s per linear meter of clean drain (theoretical value calculated with shutter hypothesis 20 mm).
- Wall thickness (All models): 3 mm

# ASSEMBLY INSTRUCTIONS - DRAIN WELL BOX PICF

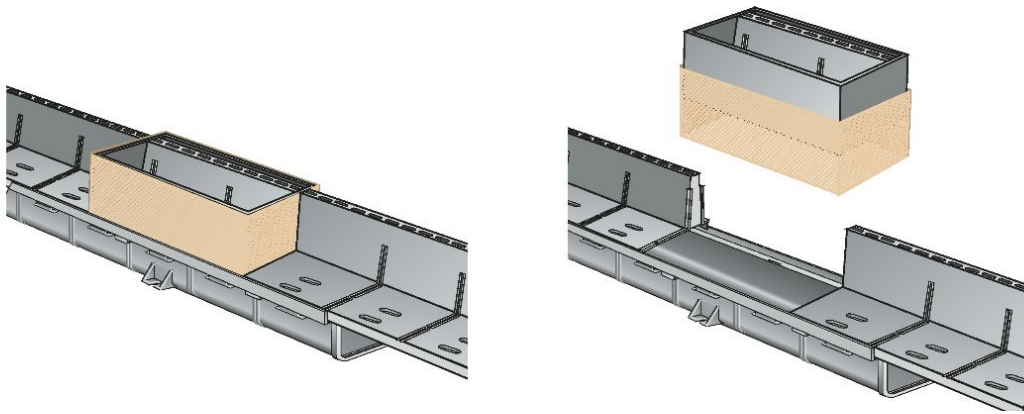

- 01** Lay the inspection box (PICF) on the drainage channel and close by slotted grate (PCF). Build a kind of frame around the inspection box using strong enough material (plastic, metal, wood) and 1mm thick.

This frame has the purpose to avoid the concrete to stick and to lock the inspection box.

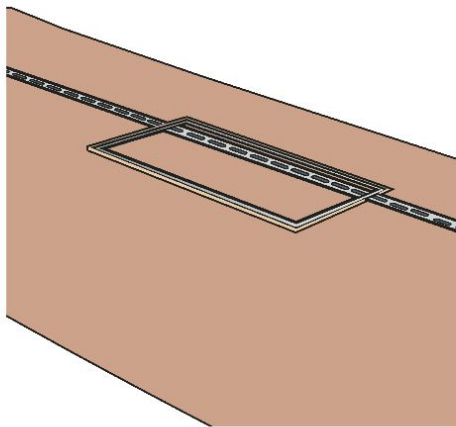

- 02** Put the concrete around the drainage channel and then use the chosen cover (tiles, marble, brick). Fill the space into the inspection box with the same cover material.

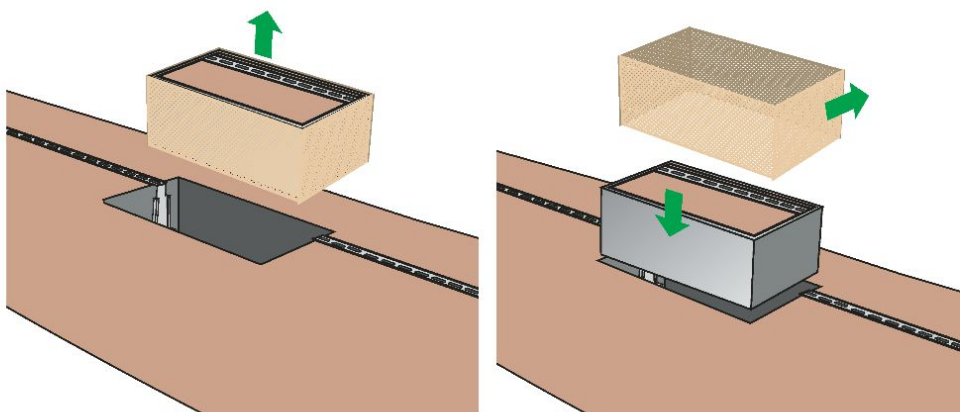

- 03** Once the paving is dry, remove the inspection box, remove and then throw away the frame. To remove the box, you can use a tool like a hook.

