

## Gully trap with bituminous membrane

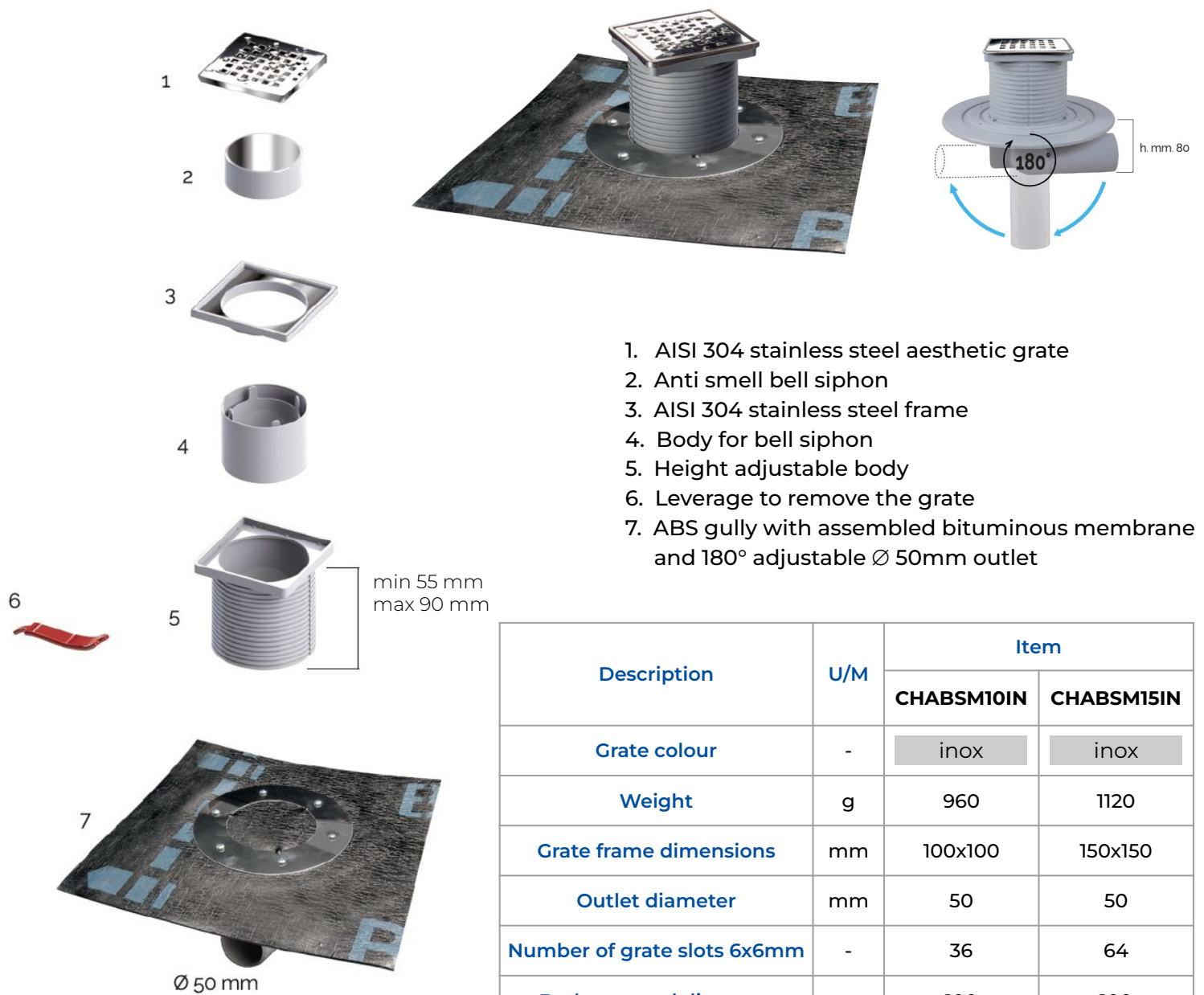

1. AISI 304 stainless steel aesthetic grate
2. Anti smell bell siphon
3. AISI 304 stainless steel frame
4. Body for bell siphon
5. Height adjustable body
6. Leverage to remove the grate
7. ABS gully with assembled bituminous membrane and 180° adjustable Ø 50mm outlet

Description	U/M	Item	
		CHABSM10IN	CHABSM15IN
Grate colour	-	inox	inox
Weight	g	960	1120
Grate frame dimensions	mm	100x100	150x150
Outlet diameter	mm	50	50
Number of grate slots 6x6mm	-	36	64
Body external diameter	mm	100	100
Body internal diameter	mm	93	93
Total height min-max	mm	145 - 260	145 - 260
Water flow (UNI EN 1253)	l/min	47	47

**Material:** ABS (body), Stainless steel (frame, grate)

**Features:** Gully trap with pre-assembled 330x330mm membrane and stainless steel grate. The outlet can be 180° adjusted. The body is height adjustable.

