

Extraction fan for hoods and ducts

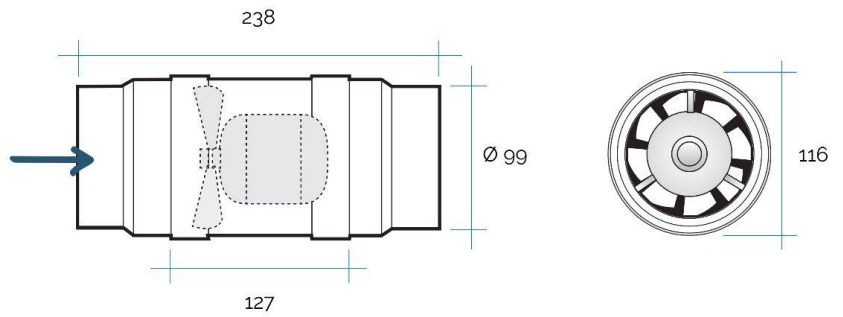

 230 V/
50HZ



Flow rate curve

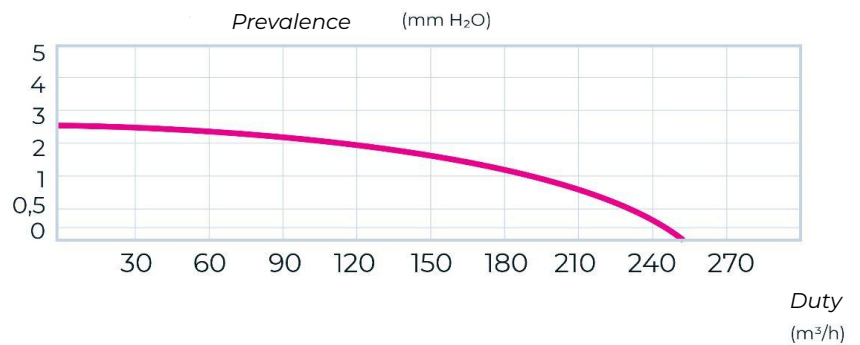

insulation
class II



Item	Dim. mm	Ø Hole mm	Flow rate m ³ /h	P watt	Noise dB
AS1012B	235x118	100/125	250	10	28

Description: Extraction fan for hoods and ducts ø 100 / 120 mm

Material: ABS plastic

Colour: White

Features: The extraction fan is made entirely of plastic and is resistant to fatty acids in food. It solves the problem of hood draft, in all those cases where for any reason it is not possible to install an underhood extractor. It can be adapted to both ø 100 mm and ø 120 mm pipes using unscrewable fittings. Thanks to the versatility of application within a ducted air system, the extractor can also be applied before the air outlet grille on the outside wall or at any point of the ducting. Suitable for ducts with temperature of 80°C max.

